



FOR YOUR SAFETY, ALWAYS USE A HELMET

NOTE: WE RECOMMEND THE USE OF A FULL HELMET. IT COMPLETELY COVERS THE HEAD AND PROVIDES MORE INSULATION FROM NOISE AND AIR.

www.mototecusa.com

MotoTec®



MotoTec 105CC Mini Bike

WITH MOTOTEC, DO MORE

WARRANTY POLICY, USER MANUAL, ASSEMBLY MANUAL

Dear Customer:

Thank you for your confidence in choosing **MotoTec**.

Your new Mini Bike model has a 4-stroke, overhead camshaft (OHC), 105cc and 3.5 hp engine, **IT WAS DESIGNED AS A RECREATIONAL VEHICLE**. We hope it meets your best expectations and we send you our best wishes.

Feel it, Ride it, Love it



INDEX

⚠ Ⓞ IMPORTANT POINTS	3	TAKING CARE OF THE MINI BIKE	24
⚠ BEFORE YOU BEGIN	4	WASH	24
WARRANTY	5	TAKING CARE OF YOUR PAINT	24
SECURITY POINTS	8	SEAT CARE	24
ASSEMBLY INSTRUCTIONS	9	⚠ Ⓞ CHECK BEFORE DRIVING	26
LOCATION OF PARTS	12	OPERATING INSTRUCTIONS	27
FRONT TOP VIEW	12	STARTING THE ENGINE	27
REAR BRAKE LEVER	13	STOPPING THE ENGINE	27
CURRENT KILL SWITCH	13	MOTOR FLOODED	27
ACCELERATOR	13	STORAGE	28
CHOKE	14	RETURN TO USE	28
LEFT SIDE	15	DRIVING SAFETY	29
RIGHT SIDE	16	PROTECTIVE EQUIPMENT	29
FUEL VALVE	17	CARGO OF PASSENGERS OR GOODS	29
MANUAL PULL STARTING	17	ROAD CONDITIONS	29
VEHICLE IDENTIFICATION NUMBER	17	RAINY DAYS	30
PERIODIC REVIEWS	18	MODIFICATION OF THE DESIGN	30
ADD GASOLINE	18	DRIVING AND ALCOHOL	30
ENGINE OIL LEVEL	18	DRIVING RECOMMENDATIONS	30
CHANGING THE ENGINE OIL	19	POSTURE FOR DRIVING	31
CLEANING THE SPARK PLUG	20	CARE TO AVOID THEFT	31
AIR FILTER	20	TECHNICAL DATA	32
ADJUSTING THE THROTTLE POINT	21	CONDITIONS TO BE RESOLVED	33
TIRES	22		
⚠ STORAGE SERVICES	23		





ATTENTION:

It refers to the driver's safety being in danger. Ignoring this information can cause serious injury.

① NOTE :

It refers to special procedures and precautions that must be followed to avoid damage to your **Mini Bike**. In addition, they make the maintenance easy and the instructions clearer.

ECOLOGICAL NOTE :

We take care of our environment.

Feel it, Ride it, Love it

BEFORE STARTING



This manual contains important information about the handling of your **Mini Bike**, as well as advice for its care and relevant information for your safety, so we recommend that you read it carefully before starting to use it.

This manual is one more component of your **Mini Bike**, in case you sell it, please hand it over to the new owner so that he knows all its characteristics, both operating and maintenance.

All information included in this manual is based on the latest data received from people at the time of its publication.

MotoTec reserves the right to modify the manual at any time, without prior notice. No part of this manual may be reproduced in any way or by any medium, without prior written authorization from **MotoTec**.

To avoid mishaps, before using your **Mini Bike**, check that all its parts and components are in perfect condition.

Feel it, Ride it, Love it





Feel it, Ride it, Love it



WARRANTY

WARRANTY CONDITIONS

60 DAYS FROM RECEIVE DATE

- 1.-To make the Guarantee valid, the owner must appear at a **MotoTec** authorized dealer.
- 2-The warranty covers the defects as well as the material due to manufacture and / or assembly.
- 3.-The establishment that sold you the **Mini Bike** has the obligation to provide you a valid receipt, otherwise the Guarantee cannot be made valid.
- 4.-The Warranty does not cover corrosion on the inside of the paint, chrome or nickel plating, due to environmental conditions or external agents.
- 5.-The Guarantee does not cover expenses caused and / or derived from the maintenance of the **Mini Bike** itself, such as cleaning , lubrication , tire punctures, etc
- 6.-**MotoTec** is not responsible for damage to your person, to third persons and property to alien, as well as accidents, bad transportation and any situation generated by misuse of the **Mini Bike**
- 7.-The present Guarantee Policy only validates the **Mini Bike** written in the Guarantee Certificate and cannot be used for other units.
- 8.-If the Warranty is not due to the personnel due to negligence in driving, different use for which it was designed, lack of maintenance services or in compliance with any of the guideline of this Policy, will be sufficient cause for the Client to pay the cost of said revision and / or repair to the Authorized **MotoTec** Service Center.
- 9.-The Guarantee may be transferable to sub-entity owners for the remaining period of the same; these have been fulfilled only if it has satisfactorily with the terms and conditions described are valid. Otherwise, during the remaining period, the Guarantee will not be valid for the subsequent owners.



THE WARRANTY IS NOT EFFECTIVE IN THE FOLLOWING CASES:

- 1.-Failure or defects caused by the use of spare parts and / or accessories that are not original.
- 2.-Failure to be defective and to perform any of the maintenance services indicated in this policy and / or manual.
- 3.- Failure or defect, attributed to neglect, misuse, different use than indicated in the User Manual, including falls.
- 4.-Failure or defects caused by modifications and / or alterations to the motor, the electrical system, the suspension, the brakes or to any other component of the Mini Bike.
- 5.-Failure or defects derived or attributed to improper repair or maintenance
- 6.-Failure to be defective or attributed to the rent of the Mini Bike or to handling in competition.
- 7.-Failure or defective consequence of some natural content such as hail, earthquake, floods, hurricanes, between others; as well as fire, shock, robberies and damage based on these situations.
- 8.-Failure or defective intentionally or accidentally caused by the owner or third party, due to force majeure or fortuitous events.
- 9.-In parts of natural gas such as: filter, chains, brake pads, shock absorbers, suspension, system of carburetor, tire, spark plug, engine, transmission, because parts that wear out or can easily be damaged days.
- 10.-Failure or defects caused by the low or high level of oil in the engine and / or the use of lubricants not recommended by MotoTec
- 11.-Failure or defect is caused by overheating the engine.

REQUIREMENTS TO VALIDATE THE WARRANTY

- 1.-Have the Guarantee Certificate duly filled and stamped by the establishment where the **Mini Bike** was acquired.
- 2.-Not having made any modifications to the **Mini Bike**
- 3.-Having performed all the maintenance services indicated by an Authorized **MotoTec** Service Center.

SECURITY POINTS

Below we provide the following points that you should take into account before using your **Mini Bike**

ATTENTION

The Mini Bike is suitable for children 16 and up With a maximum weight of (185lbs)
Adult supervision required

ATTENTION

The Mini Bike is designed to be driven by one person.

ATTENTION

The Mini Bike is not designed for jumping or cross country.

ATTENTION

Do not drive your Mini Bike if you have used Alcohol or Drugs

ATTENTION

The Mini Bike is not designed to carry a maximum load over (185lbs)

ATTENTION

Before Children use the Mini Bike, an adult is responsible for their skill level and ability



ATTENTION

The Mini Bike is not equipped with front brakes, directional lights or rear lights, so it cannot be used on the street.

ATTENTION

Do not drive the Mini Bike unless you have received instruction.

ATTENTION

Always wear a full helmet, and protective clothing that meets safety standards.

INSTRUCTIONS TO ASSEMBLE YOUR MINI BIKE

Before assembling your Mini Bike it is important that you have the following tool: cutter pliers, 10, 12 mm socket or wrench and cross point screwdriver.

1

Remove the trim cover by cutting the straps.



⚠ Caution

When cutting the straps, be careful not to insert the cutter into the box as you can damage the seat or any other component.

2

Cut the cinch fastening the fork with the structure.

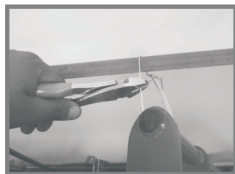

3

Remove the bag that contains the tools, the User's Manual, hardware and separate the components.



4

Remove the screws that hold the metal frame to the bottom base and remove the frame evenly, taking care not to scratch or damage the **Mini Bike**



ASSEMBLY INSTRUCTIONS

5

Carefully cut the strap that holds the handlebars with the fork of the Mini Bike



1 person



PINZAS DE CORTE

⚠ Caution

To avoid damaging the paint, cut ties with pointed pliers

6

Place the lower parts of the clamps on the base of the fork.

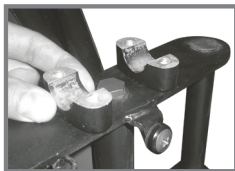

1 person

⚠ Caution

The bottom of the clamps should be centered with holes in fork

7

Place the handlebars over the lower parts of the clamps, install the upper clamps and tighten.



1 person



10 Y 12 MM

⚠ Caution

Handlebars should be centered with clamps

8

Remove the screws that secure the front trim cover, located on the front of the fork.



1 person



Phillips
Screwdriver

⚠ Caution

Be careful not to lose the rubber of the screws

9

Install the decorative plastic cover on the front of the Mini Bike



⚠ Caution

Small washer behind cover.
Largest washer in front of cover.



1 person



Phillips
Screwdriver

11

Carefully remove the Mini Bike from the metal base (load the Mini Bike from the back, turning it to the side to remove it from the base and then carry out the same process to control it from the front part) and place the Mini Bike on its side stand.



1 person

10

Remove the missing pieces that hold the Mini Bike to the metal base.



1 person



10 MM

LOCATION OF PARTS

TOP VIEW OF THE ANTERIOR

(A) Rear brake lever

(B) Kill Switch

(C) Throttle grip

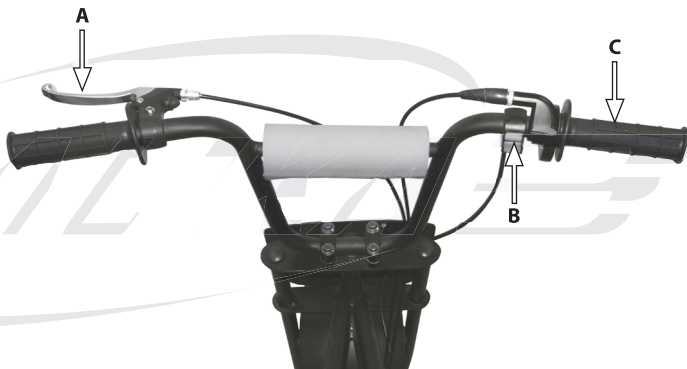

Feel it, Ride it, Love it

REAR BRAKE LEVER

The rear brake lever is the mechanical component that allows you to slow down and / or stop the Mini Bike

CURRENT CUT SWITCH

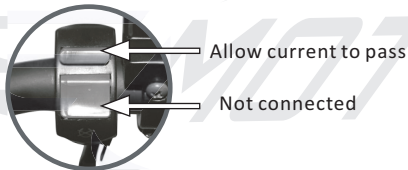



Image 1 Short current switch.

“” Allow current to pass
When the current cut-off switch is in this position, the Mini Bike can be turned on.

“” Not connected
When the current cut-off switch is in this position, Mini Bike cannot be turned on.

TWIST THROTTLE

The accelerator is the mechanical component that allows you control the speed at which the Mini Bike travels. throttle rotates counterclockwise of the clock.

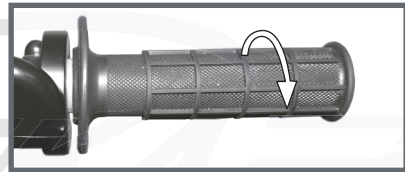

Image 2 Twist Throttle

LOCATION OF PARTS

CHOKE

The throttle blocks the passage of air in the fuel mixture that reaches the engine. It has 2 positions:

Image 3

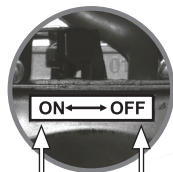

Posición
" ON "

Posición
" OFF "

(A) Posición "START"

(B) Posición "RUN"

Feel it, Ride it, Love it



LEFT SIDE

- (A) Choke
- (B) Silencer / Exhaust
- (C) Kick Stand
- (D) Drive chain



⚠ Attention:
Gasoline burned by Silence / Exhaust contains carbon monoxide, which is harmful to your health or can cause death. Always start the engine in open places.

LOCATION OF PARTS

RIGHT SIDE

(A) Fuel valve

(B) Seat

(C) Rear disc brake

(D) Pull Start

(E) Spark plug



FUEL VALVE

The fuel valve has 2 functions which are:

OFF' Block passage from gasoline to carburetor

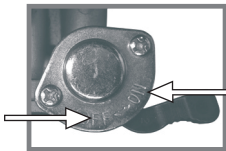

"ON" Allow the passage of gasoline to the carburetor

Picture 4. Fuel valve

"ON" Allow the passage of gasoline

When the fuel valve is in this position, gasoline flows from the main tank to the fuel.

"OFF" Block the passage of gasoline

When the fuel valve is in this position, gasoline does not flow from the tank. The valve must be stationary when the Mini Bike is parked for long periods of time.

MANUAL START ROPE

The manual starter rope is the mechanical device that allows you to start the motor of your **Mini Bike**.

Image 5: Manual Pull Start

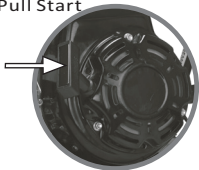

Image 5. Manual Pull Start

VEHICLE IDENTIFICATION NUMBER (VIN)

The VIN is:

The only way to identify your particular Mini Bike from another of the same model or type.

On some occasions it is necessary to request spare parts. In case of theft, it is necessary for the authorities to identify your **Mini Bike**. The VIN is engraved in the central part of the box.



Image 6. Vehicle identification number.

The motor number is engraved in the central part of the motor body.

Attention:

It is a crime to remove or manipulate either of these two numbers.

Important:

Check that the VIN that comes with your invoice matches the VIN of your Mini Bike.

PERIODIC REVIEWS

ADD GASOLINE

Using higher octane gasoline. This gasoline produces few impurities in the ignition spark plug and improves the life of the engine.

The fuel tank is located below the center frame and it has a capacity of 1.2 liters. To add gasoline to the fuel tank you must:

- 1.Shut down the engine.
- 2.Get off the **Mini Bike**
- 3.Place the **Mini Bike** on the side stand.
- 4.Remove the cap from the tank by turning it in the opposite direction, clockwise, see image 7.
5. Add gasoline without going over the mark on the inside of the tank neck.
- 6.Place the top of the tank and turn it clockwise.



Image 7. Add gasoline.

⚠ Attention:

Gasoline is highly flammable and explosive. To avoid accidents you should:

- Stop the engine before adding gasoline.
- Add gasoline only outdoors.
- Wipe up any gasoline that may have spilled immediately with a damp cloth to avoid damaging the **Mini Bike**.

ENGINE OIL LEVEL

Check the oil level every day before turning on the engine of your **Mini Bike**. To check the oil level you must:

- 1.Place the **Mini Bike** on a horizontal surface, don't use the side stand and do not tilt it.
- 2.Locate the crankcase plug on the bottom of the **Mini Bike** engine body, see image 8.
- 3.To loosen, turn in the counterclockwise direction.
- 4.Remove the oil plug.
5. Completely clean the excess oil from the oil plug with a cloth.
- 6.Locate the marks for the maximum and minimum oil level on the oil plug.
- 7.Insert the oil plug without screwing.
8. Re-pull the oil plug again.
- 9.Check the location of the oil level, the oil should be at the maximum mark, see image 8.
- 10.Add SAE10W-30 oil if the level is below the minimum level.
- 11.Replace the oil plug.
- 12.Turn the oil plug clockwise.

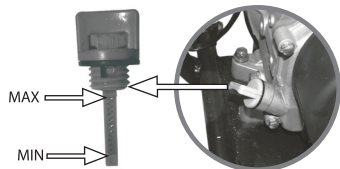

Image 8. Circuter bayonet plug.

ⓘ Note:

Regularly check the oil level, in the event of a leak or the oil level not adequate, present your **Mini Bike** to the nearest **MotoTec** Authorized Service Center.

ⓘ Note:

Never exceed the upper oil level, it may cause damage to the motor.

⚠ Attention:

When you use your **Mini Bike** under conditions of a lot dust, you should change the engine oil immediately.

The engine oil should be changed at the service maintenance (See Maintenance Services page 23).

To change the motor you must:

1. Place the Mini Bike on a horizontal surface.
2. Make sure the engine is hot and / or warm so that the oil drains completely.
3. Locate the oil plug in the lower part of the body of the **Mini Bike** engine.

4. Loosen the clock hands in the opposite direction and remove it.

5. Remove the drain bolt from the bottom of the engine body, see image 9.

6. Drain the oil into a container for 5 minutes.

7. Install the drain screw and turn it clockwise and apply a torque of 24N-m (18lbs.ft.).

8. Put 500ml of oil SAE10W-30.

9. Replace the oil plug and turn it in the clockwise direction.

10. Turn on the motor for a period of 1-3 minutes.

11. Turn off the engine.

12. Check if the oil level is adequate.

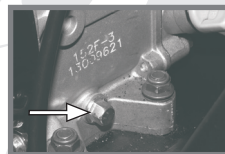

Note : Image 9. Drain screw location.

To avoid injury to a person and / or damage to the **Mini Bike** we recommend that you go to an Authorized **MotoTec** Service Center to have the oil change done.

🌿 Ecological note :

Burned oil is a toxic waste, collect the oil in a waste container and dispose of it at a used oil collection center.
DO NOT DRAIN.

PERIODIC REVIEWS

SPARK CLEANING

For proper operation, stop the Mini Bike, the spark plug must be calibrated, clean and in good condition.

To clean the spark plug you must:

1. Locate the rubber cable on the right side under the gas tank of the **Mini Bike**, see image 10.
2. Disconnect the spark plug cap.
3. Clean any dirt around the base of the spark plug.
4. Remove the spark plug with a 19mm wrench from the same contrary to the clock hands.
5. Clean the spark plug of carbon deposits and oil.
6. Check the calibration of the spark plug electrodes, which should be 0.6 to 0.7mm, see image 10.
7. Install the spark plug, tighten first with your hand, then finish tightening with the 19mm wrench, and apply a torque of 15 to 18 N-m (11 to 13 lbs.ft).
8. Place the hood on the cap.
9. Check that the cap is holding the spark plug correctly.

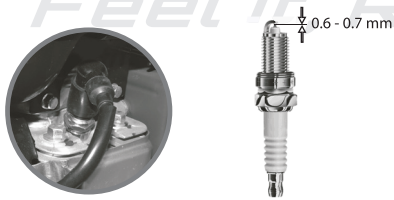

Image 10. Spark Plug

ⓘ Note:

We recommend that you go to an Authorized **MotoTec** Service Center to have the spark plug cleaned.

ⓘ Note:

If the spark plug electrode showed erosion, sediment or the calibration is not adequate, go to your Service Center nearest **MotoTec** authorized to be replaced.

AIR FILTER

The filter has the function of capturing all the impurities that exist in the air to extend the useful life of the engine, so it must be changed or cleaned at each maintenance service. See Maintenance Services page 23. The air filter is located on the rear of the engine. To remove the air filter you must:

1. Remove the lid very carefully by unhooking the tabs and holding them with the air filter assembly.
2. Remove the filter element, see image 11.
3. Clean the air filter and replace it.
4. Place the air filter and switch in its position.

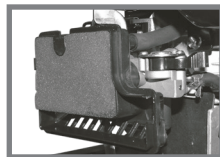

Image 11. Air Filter

① Note:

To clean and / or replace the air filter, go to your nearest **MotoTec** Authorized Service Center.

① Note:

Do not use flammable cleaning thinner to clean the element of the filter. If the filter is of dry type (paper) you must replace it with a new one.

① Note:

The air filter should not be installed broken, since it allows the dust passing to the motor, reducing its life drastically.

🌿 Ecological note:

Used air filters are toxic and present a risk to the environment if not properly disposed of. Do not throw them in the trash, take them to a collection center.

ACCELERATOR POINT ADJUSTMENT

For proper operation of the throttle, it is necessary to check that the free play of the throttle grip is within the specification of 2 to 6mm. If it is not within the specification, you must:

1. Locate the adjusting screw and nut, see image 12.

2. Fasten the screw and loosen the force.

3. Turn the adjusting screw to bring it within specification.

4. Check that the throttle free play is within the specification, also that the rotation is smooth from the closed position to the open position. Picture 12.

5. Fasten the screw and fasten it to your nut.

6. Turn on the motor to ensure that it works correctly in case the operation is not adequate, repeat from step 2 to 6.

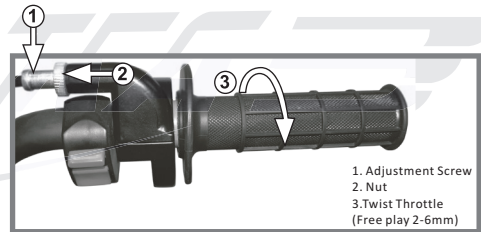

Image 12. Adjustment of the throttle.

① Note

If you can't place the free play of the throttle grip within the specification, go to your nearest **MotoTec** Authorized Service Center.

PERIODIC REVIEWS

TIRES

The tires that come from fabric are still designed according to the performance capability of your **Mini Bike**, providing the best combination of handling, braking, durability and comfort. In order for your Mini Bike to work properly, the tires must:

- Be of the correct type and size
- Be in good condition.
- Have a suitable profile.
- Have adequate pressure.

Tires with low pressure wear significantly uneven, affect handling and are prone to failure due to heating. Tires with high pressure cause a hard ride, they wear out uneven and prone to damage depending on road conditions.

Front tire pressure: 10-15 Pounds per square inch (psi)

Rear Tire Pressure : 10-15 Pounds per square inch (psi)



ⓘ Note :

Tire pressure should be measured when they are cold. If the pressure of a hot tire is adjusted to the cold recommendation, the pressure reading is higher and the tire will not have enough air.

⚠ Attention:

Using very worn tires with inadequate pressure can cause accidents. Every time you check the tire pressure, you should also check the profile and side walls for wear, damage and extra objects. You should pay attention mainly to:

- Bumps.
- Cuts.
- Cracks or fissures.
- Excessive profile wear

⚠ Attention :

If when driving your Mini Bike you go through a pothole or hard object, stop hills as soon as possible and check for tire damage. If a tire is punctured or damaged, it should be replaced as soon as possible.

A repaired tire is not reliable as a new one and may fail while driving. If you temporarily repair a tire by placing a patch or using spray sealant, drive carefully at low speed when changing a tire, go to your **MotoTec** Authorized Service Center.

⚠ Attention :

Installing the wrong tires on your **Mini Bike** can affect handling and stability.



FAILURE TO perform Maintenance Services VOIDS THE WARRANTY.

Performing the maintenance services of your **Mini Bike** for time is the best way to protect your version. Timely maintenance prevents, in most cases, future problems likewise your **Mini Bike** has a warranty period which continues in force If you do not carry out maintenance services at the **MotoTec** Authorized Service Centers. The following table indicates the periods and activities to be performed according to a normal procedure.

MAINTENANCE ITEM	SERVICES				
	Every Use	Every 20 Hours	Every 3 Months	Every 6 Months	Every Year
Check the oil level of the engine	√				
Change the oil of the engine		√		√	
Air filter check	√				
Air filter cleaning			√		
Change the air filter					√
Carburetor cleaning			√		
Cleaning and calibrating spark plug				√	
Change spark plug					√
Adjustment and lubrication of traction chain					
Review and adjustment of marks					
Cleaning the fuel tank and fuel filter					
Fuel valve strainer cleaning					√
General tightening of screws			√		
Traction chain check	√				
Brake check	√				
Revive the free play of the throttle grip	√				
Clutch adjustment and lubrication		√	√		

TAKING CARE OF THE MINI BIKE

CLEANING

The best protection against environmental influences is to frequently wash your **Mini Bike**. The frequency depends, among other factors, of the use that you give, of the season of the year, the atmospheric conditions and the environment.

The longer you need to stay on the **Mini Bike** the bird droppings are the remains of insects, the resins trees, dust, particles of soot and other sediment aggressive in nature, more persistent in its destructive effects.

To wash your **Mini Bike** you must:

1. Rinse with cold water to remove loose dirt.
2. Wash it with a mild cloth, soapy solution and cold water.
3. Rub the dirty areas.
4. Rinse with plenty of clean water.
5. Dry it with a soft, dry cloth.
6. Start the engine and let it run for 1 to 3 minutes.

① Note :

Avoid using high pressure water, as it can damage parts of the Mini Bike. If you use water wash at pressures and recommend do not apply the following parts :

- Under the seat.
- Kill switch.

- Wheel rims.
- Muffler / Exhaust outlet.
- Controls.
- Motor.
- Carburetor.
- Dust Cover.
- Electrical parts and their connectors.

▲ Attention

After washing your **Mini Bike**, the functionality of the brake is partially and temporarily affects the braking distance to avoid accidents.

CARE OF THE PAINTING

A good application of maintenance products protects the painting of the **Mini Bike** against the influences of the environment and even against other factors of sun light.

The paint can be deserted or given to liquid within a week after having been delivered by the **Mini Bike**. It is recommended at least it would give the paint one coat of liquid to two times a year.

SEAT CARE

The outer parts made of synthetic materials, such as the seat, they are cleaned with a normal wash. You can use special cleaning and maintenance products for synthetic materials and artificial leather that do not contain solvents.

Normal cleaning

Wipe the surfaces of dirty plastic materials with a cloth slightly damp cotton or wool.

Embedded dirt

Clean stubborn dirt with a damp cloth on a light solution mild soap (2 tablespoons neutral soap with 1 liter of water) .When doing so, make sure that the material synthetic does not soak anywhere and that the water does not seek through the seams. Dry with a soft and dry cloth

Spot cleaning

Remove recent water-based product stains, such as coffee, tea, juices, etc., with an absorbent cloth or paper towel.

Remove recent stains from grease-based products as well , like butter, mayonnaise, chocolate, etc., with a cloth absorbent paper or paper towel. Use a spray to dissolve grease for dry grease stains.

Treat special stains like ballpoint stains marker, nail polish, etc. with a stain remover especially for synthetic materials.

CHECK BEFORE DRIVING



Take care of yourself and take care of your **Mini Bike**, do this review every time you get on your Mini Bike.

Concept	Activity
Fuel	Check that the amount of gasoline is sufficient for the run. See Adding Gasoline, page 18
Oil	Check that the oil level is at the maximum mark, add if necessary. See Engine Oil Level, page 18.
Throttle	Check that the free play of the throttle is between 2 and 6mm, adjust and lubricate if necessary. See Throttle Knob Adjustment, page 21.
Tires	Check the tire resistance that did not present in blows, cuts, cracks or excessive wear profile. See Tires, page 22.

Feel it, Ride it, Love it



STARTING THE ENGINE

To turn on the motor you must:

1. Place the **Mini Bike** on the side stand.
2. Place the fuel valve in the "ON" position.
image 13-A.
3. Check that the amount of fuel is sufficient for your trip. See Add Gasoline page 18.
4. Place the choke lever in the "START" position.
image 13-B
5. Place the cut-off switch in the on position
6. Press the rear brake lever.
7. Take the start rope and pull hard.
8. When the engine starts, gradually move the choke lever to the "RUN" position.
9. Wait about 1-3 minutes to use your **Mini Bike**.



Imagen 13.

A

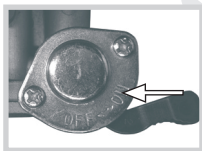

Posición

"RUN"

B

Posición

"START"

STOP THE ENGINE

To turn off the engine you must:

1. Come to a complete stop by pressing the rear brake.
2. Set the circuit breaker to the on position .
3. Place the **Mini Bike** on the side stand.

FLOODED ENGINE

If the engine fails to start after several attempts it is possible that it is flooded with gasoline. To free the engine from excess gasoline you must :

1. Wait 1 minute for it to clear.
2. Set choke lever to "START" position
3. Set the circuit breaker to the "ON" position.
4. Do not operate the throttle when starting.
5. Try to start the engine again.

ⓘ Note:

Image 13.Engine starting.

Do not let the engine run for more than 3 minutes each total since there may be overheating, remember that the cooling system is by air and not by fan.

If your mini bike has any problems, please contact us. www.mototecusa.com Do Not Return to the Store. **MOTOTEC**

STORAGE

Storage for long periods of time requires of certain items to avoid damaging the **Mini Bike**. To store you must:

1. Drain the oil from the engine.
2. Drain the gasoline from the fuel tank.
3. Place the fuel valve in the "OFF" position
4. Thoroughly clean the **Mini Bike**
5. Remove the spark plug. See Spark Plug Cleaning page 20.
6. Put 15-20ml of oil into the spark plug gap.
7. Pull the starter rope several times to get out excess oil.
8. Put the spark plug.
9. Keep the **Mini Bike** in a cool and dry place. Do not expose it to the sun.
10. Place a protective cover over the **Mini Bike**.

ⓘ NOTE:

When you use your **Mini Bike** again, at the time of lighting it, smoke will come out of the exhaust until all the oil that is placed in the spark plug space is burned.

⚠ ATTENTION:

Before driving your Mini Bike, you must make sure that it's found in good condition, for them we recommend try it in a safe place.

RE-USE

To use the **Mini Bike** after a long period of storage must:

1. Clean the **Mini Bike**.
2. Add engine oil.
3. Add gasoline. See Adding Gasoline page 18.
4. Set the fuel valve to the "ON" position.
5. Check tire pressure. See page 22.



Driving your Mini Bike is an exciting activity, but requires safety precautions. The main ones are:

PROTECTIVE EQUIPMENT

For your protection, when driving your Mini Bike you should use the following equipment:

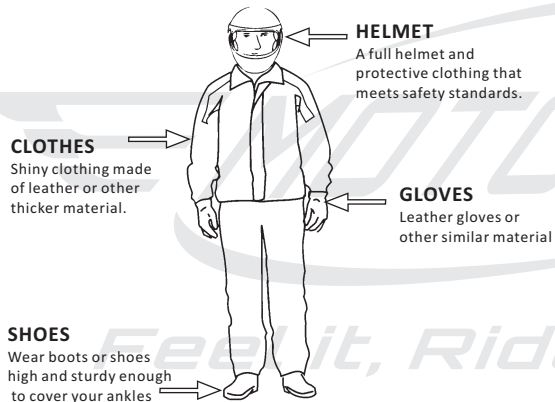

Attention:

Dressing in loose clothing can cause serious damage to the driver and **Mini Bike**, as it can be caught in the handwheel, on the starter rope, on the foot post, on the drive chain or rims.



Attention:

The temperature of the exhaust of the **Mini Bike** is high, to avoid burns, it is recommended to use boots or a pants that covers the foreleg.

CARGO OF PASSENGERS OR GOODS

The **Mini Bike** is designed to transport cargo maximum (driver) of 185lbs). Exceeding this limit affects its stability, can cause accidents and damage to the **Mini Bike**.

MotoTec is not liable for any reason whatsoever due to overloading. To prevent accidents, avoid overloading:

- Bulky objects weighed on the **Mini Bike**
- Objects obstructing the driver's visibility.

ROAD CONDITIONS

Consider that anything can get in the way on a road, so you should always drive carefully and slow down enough when necessary.

It is recommended that when you meet with :

- Puddles of water, avoid sitting in them and you can lose the control of the direction or may fall depending on the speed with which you enter.

DRIVING SAFETY

Sand, mud and fallen leaves, avoid them or run over them at low speed, since you can lose direction or skip.

If possible, take the **Mini Bike** and walk on the road

Bumps, reduce speed and cross at right angles.

Gravel and potholes, drive carefully, keeping an eye on the road conditions and with your waist slightly raised to balance it.

Iron plate, stop the **Mini Bike** and walk with it now that these surfaces are very slippery, especially on rainy days.

Oil or frozen roads, drive slowly or stop the **Mini Bike** and walk with it.

RAINY DAYS

Driving your **Mini Bike** in the rainy weather can be dangerous, so we recommend you:

- Reduce your speed more than on a clear day as the rain prevents you from seeing obstacles and determining road conditions.

- Do not take curves at the same speed as on a clear day, since you can slip, fall or get off the road.

MODIFY THE DESIGN

Modifying or changing non-original parts is up to your **Mini Bike**, not only affects the safety of the **Mini Bike** or its occupant, it also causes the loss of the Warranty.

DRIVING AND ALCOHOL

Using your **Mini Bike** under the influence of alcohol is one of the most frequent causes of accidents. The ability to driving is impaired when the alcohol level in the blood was found to be above the maximum level allowed by the law, because your reflexes become slow and your ability decision is impaired. If you have drink, **DO NOT DRIVE** your **Mini Bike**.

DRIVING RECOMMENDATIONS

When driving, be careful or to ensure your safety, so before using your **Mini Bike** we recommend:

1. Review and / or adjust some components of natural wear due to use as:
 - The oil level in the engine.
 - The air pressure of the tires.
 - Brake wear.
2. Wear clothing in flashy or bright colors.
3. Hold the handlebar with both hands.
4. Be careful to cross are on street corners, and in the entry and exit of vehicles.

Attention

We suggest you practice driving your **Mini Bike** in an area free of transit so that you are completely familiar with the machine and its controls.



DRIVING POSITION

Driving your Mini Bike in a correct posture helps you so that you can use the controls easily and protect you of possible accidents Take into account the following points To acquire a correct posture :

Do not look at the feet or hands, or at a single point.

Maintain a wide field of vision looking towards everyone sides alike.

Firmly hold the center of the controls with both feet down.

Tip the knees slightly inward and not outside.

Keep shoulders relaxed in a natural position.

Bend the elbows slightly inward and relax them to these function as springs when the handle receives a blow.

Choose a position that keeps your body stable. If you have too much forward or backward slat, your shoulders and waist may be too tight and your body may have little ability.

Put your toes parallel to the Mini Bike

CARE TO AVOID THEFT

To prevent theft of your **Mini Bike** you must:

- Always leave the **Mini Bike** in a safe place.
- Avoid lending your **Mini Bike**

TECHNICAL DATA

	CONCEPT	SPECIFICATIONS
Dimensions	Model	MT-MiniBike-105cc
	Length x width dimension	1270x635mm
Load capacity	Weight	34kg (74lbs.)
	Maximum load (conductor)	61kg (135lbs.)
Motor	Type	4 stroke
	Cooling system	Air
	Engine power	3.5HP
	Boot mode	Manual starter rope
	Volume of movement	105cc
Brake	Back brake	Disc
Transmission	Speed change	Automatic

Feel it, Ride it, Love it



THE MOTOR DOES NOT START

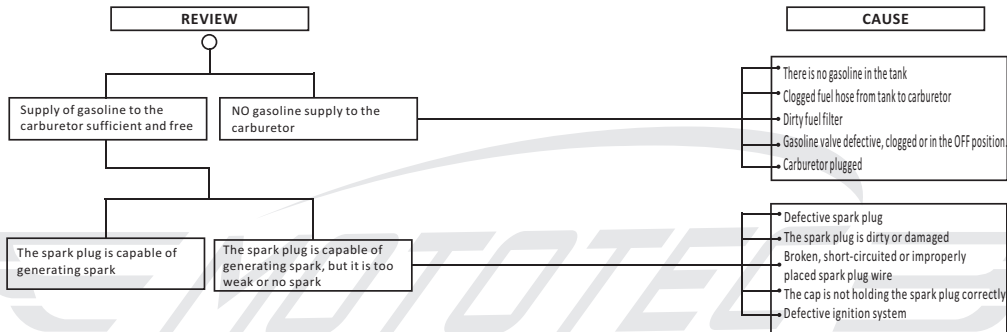

THE ENGINE STARTS BUT DOES NOT ACCELERATE



*. To avoid injury to your person and / or damage to your **Mini Bike** we recommend you go to your nearest Authorized Service Center.



Attention:

Any adjustments to the **Mini Bike** must be made or supervised by an adult.

MT-MiniBike-105cc

Made In China

MotoTec www.mototecusa.com

3700 Corporate Ave Plover WI 54467

To keep the performance good, the vehicle should be checked and maintained at certain interval.

The meanings of capital in following table are:

I: Inspection, including check, clean, lubricate, refuel, repair or replacing if necessary.

A: Inspection, adjusting if necessary C: Cleaning R: Replacing

Items	Maintenance period	Odometer (km)				
	1000	4000	8000	12000	16000	Everyday check before riding
Engine Oil	R	R	R	R	R	I
Spark Plug		I	I	R	I	
Valve Gap		A	A	A	A	
Engine Bolt		I	I	I	I	
Oil Filter		C	C	C	C	
Fuel Filter		R	R	R	R	
Air Cleaner		C	C	R	C	
Throttle Operation		I	I	I	I	
Brake Shoes/Pad Wear		I	I	I	I	

MotoTec Company– EMISSION CONTROL SYSTEM WARRANTY

YOUR WARRANTY RIGHTS AND OBLIGATIONS

The emission control system warranty period for this vehicle begins on the date the vehicle is delivered to the first purchaser other than an authorized dealer, or the date it is first used as a demonstrator, lease, or company vehicle, whichever comes first and continues for 5,000 km or 30 months, whichever comes first, provided there has been no abuse, neglect or improper maintenance of your vehicle. Where a warrantable condition exists, the dealer will repair your vehicle at no cost to you, including diagnosis, parts and labor. If an emission-related part on your vehicle is defective, the part will be repaired or replaced by the dealer. This is your emission control defects warranty.

OWNER'S WARRANTY RESPONSIBILITIES

As the OFMC owner, you are responsible for the performance of the required maintenance listed in your owner's manual. MotoTec recommends that you retain all receipts covering maintenance on your OFMC, but Mototec cannot deny warranty solely for the lack of receipts or for your failure to ensure the performance of all scheduled maintenance. You are responsible for presenting your OFMC to a Mototec dealer as soon as a problem exists. The warranty repairs should be completed in a reasonable amount of time, not to exceed 30 days.

As the OFMC owner, you should be aware that MotoTec may deny your warranty coverage if your OFMC or a part has failed due to abuse, neglect, improper maintenance or unapproved modifications.

Modification of any emission related parts including but not limited to the following as indicated below, will void this Warranty and mfr will not be responsible for any damage therefore incurred to the vehicle and Owner of the vehicle may subject to violation of law under Clean Act 2017.

- 1> Engine, and engine running idle speed;
- 2> CDI part;
- 3> Catalyst converter;
- 4> Carburetor;
- 5> Top speed governor device.

WARRANTY COVERAGE

MotoTec warrants that each new 2020 and later vehicle:

- A. is designed, built and equipped so as to conform at the time of initial retail purchase with all applicable regulations of the United States Environmental Protection Agency.
- B. is free from defects in material and workmanship which cause such vehicle to fail to conform with applicable regulations of the United States Environmental Protection Agency for the periods specified above.

Warranty defects shall be remedied during customary business hours at any authorized Mototec dealer located within the United States of America in compliance with the Clean Air Act and applicable regulations of the United States Environmental Protection Agency. Any part or parts replaced under this warranty shall become the property of Mototec.

EXCLUSIONS AND LIMITATIONS

This warranty does not cover the following:

- Failures or malfunctions of the emission control systems caused by abuse, alteration, accident, misuse, the use of leaded gasoline.
- Replacement of expendable maintenance items unless they are original equipment defective in material or workmanship under normal use, and the first required replacement interval for the item has not been reached. Expendable maintenance items include but not limited to spark plugs, filters, coolant, lubricants, gaskets, hoses and belts.
- Replacement of parts and other service and adjustments for required maintenance.
- Any vehicle equipped with an odometer or hour meter where the reading is altered so that actual mileage cannot be readily determined.
- Repairs or replacement as a result of:
 - ◇ Accident
 - ◇ Misuse
 - ◇ Use of replacement parts or accessories not conforming to the original specifications which adversely affect performance
- Physical damage, corrosion, or defects caused by fire, explosions or similar causes beyond the control of the importer
- Failures not caused by a defect in material or workmanship.

Use of the vehicle in any type of competitive racing or related events immediately and completely voids this and all other warranties.

LIMITED LIABILITY

The liability of Mototec under this Emission Control System Warranty is limited solely to the remedying of defects in material workmanship by an authorized dealer at its place of business during customary business hours. This warranty does not cover inconvenience or loss of use of the vehicle or transportation of the vehicle to from the authorized dealer. Mototec is not liable to any person for incidental, consequential or special damages of any description, whether arising out of express or implied warranty or any other contract, negligence or other tort or otherwise.

No express emission control system warranty is given by Mototec except as specifically set forth herein. Any emission control system warranty implied by law, including any warranty of merchantability or fitness for a particular purpose is limited to the express emission control system stated in this warranty. The foregoing statements of warranty are exclusive and in lieu of all other remedies. All express warranties not stated in this warranty are disclaimed. Some states do not allow limitations on how long an implied warranty lasts, so the above limitations may not apply if it is inconsistent with the controlling state law.

No dealer is authorized to modify this Emission Control System Warranty. If you have any questions regarding your warranty rights and responsibilities, you should contact MotoTec at 3700 Corporate Ave, Plover, WI 54467 (Phone: 715-955-4237 or email: sales@mototecusa.com), or the U.S. Environmental Protection Agency, 2000 Traverwood Drive, Ann Arbor, MI 48105.